



## NP24-12 NP24-12FR

Sealed Rechargeable  
Lead-Acid Battery

### 12V, 24Ah

### Specifications

- **NOMINAL VOLTAGE:** 12V
- **NOMINAL CAPACITY:**
  - 20 hr. rate of 1.20A to 10.5V 24.0Ah
  - 10 hr. rate of 2.23A to 10.5V 22.3Ah
  - 5 hr. rate of 4.08A to 10.2V 20.4Ah
  - 1 hr. rate of 14.40A to 9.60V 14.4Ah
- **WEIGHT (approx.):** 19 pounds
- **ENERGY DENSITY (20 hr. rate):** 1.30 WH/cubic inch
- **SPECIFIC ENERGY (20 hr. rate):** 15.2 WH/pound
- **INTERNAL RESISTANCE OF CHARGED BATTERY:** 10 milliohms (approx.)
- **MAXIMUM DISCHARGE CURRENT WITH STANDARD TERMINALS:** 150 amperes
- **MAXIMUM SHORT-DURATION DISCHARGE CURRENT:** 500 amperes
- **OPERATING TEMPERATURE RANGE:**
  - CHARGE 5°F to 122°F (-15°C to 50°C)
  - DISCHARGE -4°F to 140°F (-20°C to 60°C)
- **CHARGE RETENTION (shelf life) at 68°F (20°C):**
  - 1 month 97%
  - 3 months 91%
  - 6 months 85%
- **LIFE EXPECTANCY:**
  - STANDBY USE** 3 to 5 years
  - CYCLE USE (approx.):**
    - 100% depth of discharge 250 cycles
    - 50% depth of discharge 550 cycles
    - 30% depth of discharge 1200 cycles
- **SEALED CONSTRUCTION:** Can be operated in any position without leakage.
- **STANDARD TERMINAL:** Bolt Fastened Terminal or Optional Quick Disconnect .250
- **HOUSING MATERIAL:** ABS Resin
- **OPTIONAL:** Container and cover made from Flame Retardant ABS (UL94-V0/L.O.I.>28%)
- **HARDWARE:** 2-M5-.8 x 12mm Bolt w/nuts, lock washer & flat washer

#### DISTRIBUIDOR:



PLAYA SUR No. 20 INT. 2  
COL. MILITAR MARTE  
08830 IZTACALCO MEXICO, D.F.  
TEL. 7090-7088 Y 7090-7089  
ventas@regulacionups.com.mx  
www.regulacionups.com.mx

### Terminal

#### Standard

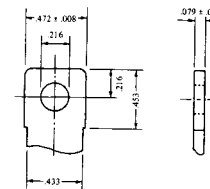

INCH = MM	
.472	12.00
.453	11.50
.433	11.00
.216	5.50
.079	2.00

#### Optional

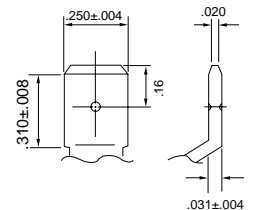

INCH = MM	
.310	7.90
.250	6.35
.16	4.0
.031	0.8
.020	0.5

### Dimensions

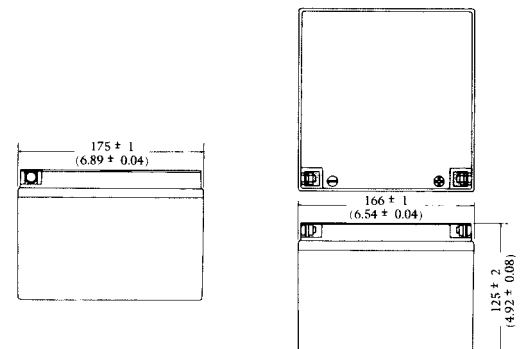

DIMENSIONS: MM (INCHES)



RECOGNIZED BY UL, File No. MH 16464

[www.regulacionups.com.mx](http://www.regulacionups.com.mx)

# EnerSys™

Power/Full Solutions™

Publication No: US-NP24-12-01 • November 2002

### DISCHARGE CHARACTERISTIC CURVES AT 25°C (77°F)

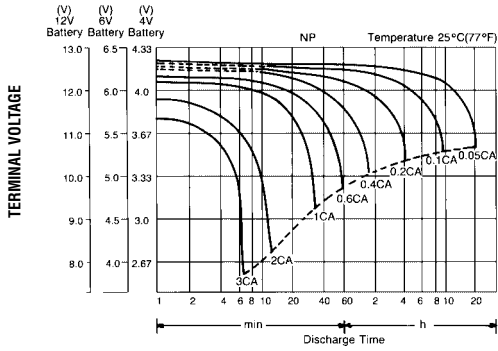

### TEMPERATURE EFFECTS IN RELATION TO BATTERY CAPACITY

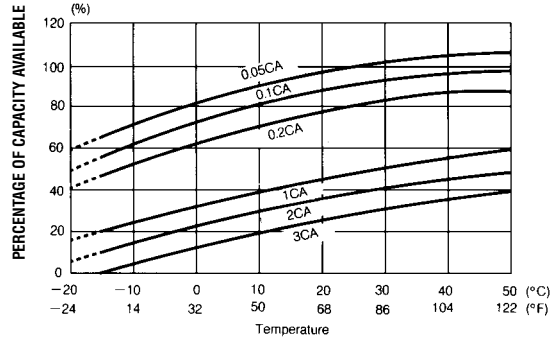

### SELF DISCHARGE CHARACTERISTICS

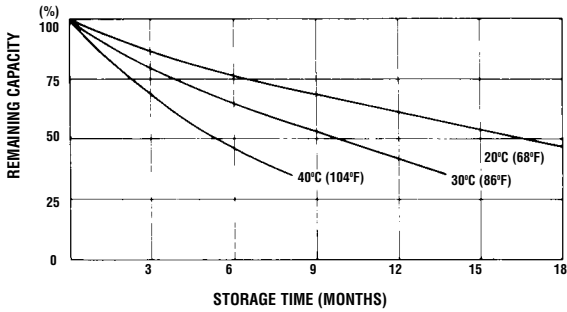

### OPEN CIRCUIT VOLTAGE VS REMAINING CAPACITY

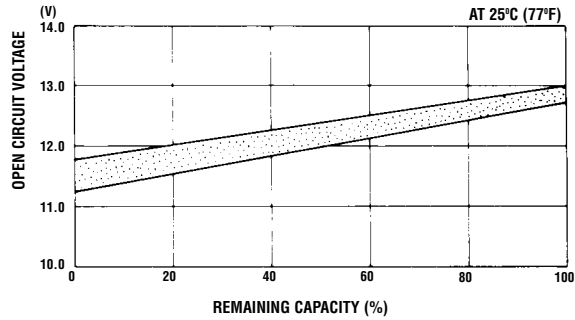

### CYCLE SERVICE LIFE IN RELATION TO DEPTH OF DISCHARGE

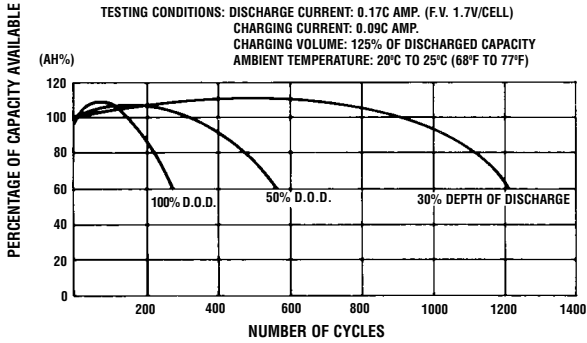

### FLOAT SERVICE LIFE

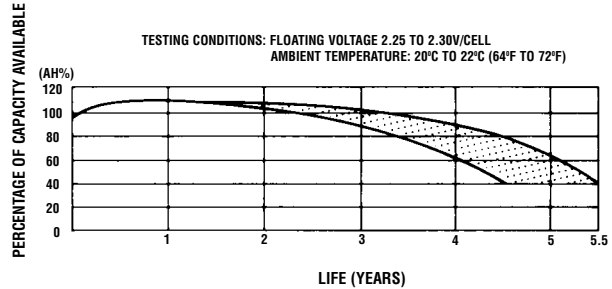

When the battery will be used by current in excess of 3C, consult with EnerSys, Inc. prior to use.

#### CHARGING METHODS (At 20°C)

**Cycle use:** Maximum charging current 0.25C  
 Charging voltage 14.4 to 15.0V  
**Standby use:** Float charging voltage 13.50 to 13.80V

**CAUTION** •Avoid short circuit  
 •Do not charge in a sealed container.



**EnerSys Inc.**  
 P.O. Box 14145  
 Reading, PA 19612-4145  
 USA  
 Tel: +1-610-208-1991  
 +1-800-538-3627

**EnerSys EMEA**  
 Brussels, Belgium  
 Tel: +32 (0)2 247 94 47  
**EnerSys Asia**  
 Guangdong, China  
 Tel: +86 755 2689 3639

#### DISTRIBUIDOR:



**PLAYA SUR No. 20 INT. 2**  
**COL. MILITAR MARTE**  
**08830 IZTACALCO MEXICO, D.F.**  
**TEL. 7090-7088 Y 7090-7089**  
**ventas@regulacionups.com.mx**  
**www.regulacionups.com.mx**